



PPA

Operating conditions

Pressure	up to 2 MPa
Temperature	-30°C to + 90°C
Speed	1 m/s

Materials

Standard	Polyurethane 90 Sh A
Alternative	Polyurethane 85 Sh A

Assembly

Eliminate any cutting edges and flash in the housing to permit assembly and prevent damage to the seals during mounting. A lead-in chamfer should be present for easy installation.

Please contact us for applications approaching maximum values.

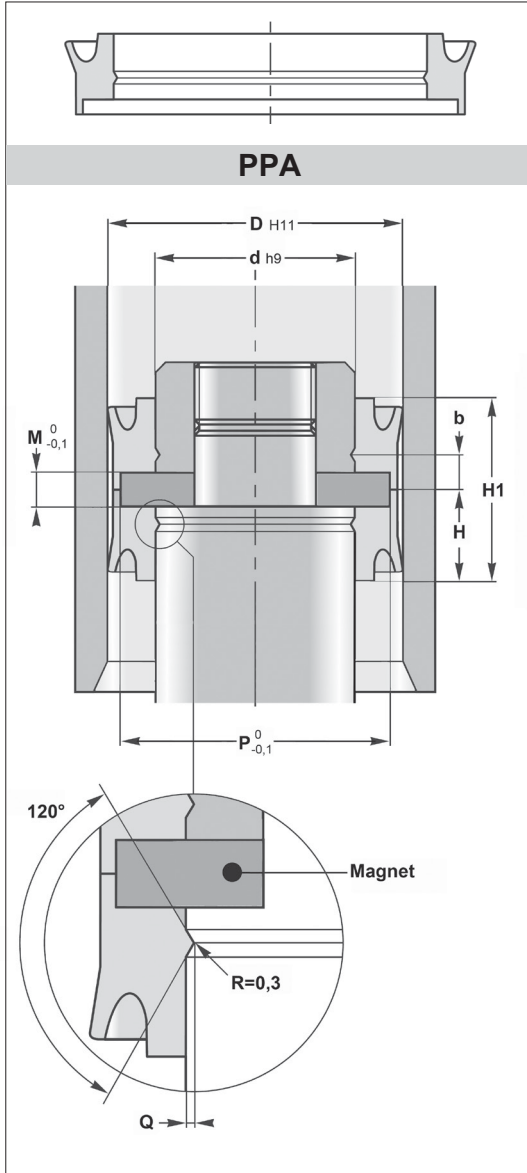

D	d	P	H	H1	M	Q	b	Reference
8	4	6,5	6	12	4	0,35	4	PPA-8
10	4	8,5	6	12	3	0,35	3,5	PPA-10
12	6	10,5	6	12	3	0,4	3,5	PPA-12
16	8	14,5	6	12	3	0,4	3,5	PPA-16
20	10	18	6	12	3	0,5	3,5	PPA-20
25	10	23	6	12	3	0,5	3,5	PPA-25